

When printing from PDF this line should measure 50mm

50mm

When printing from PDF this line should measure 50mm

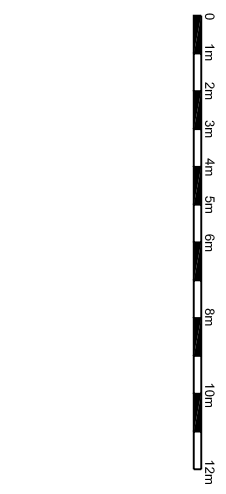
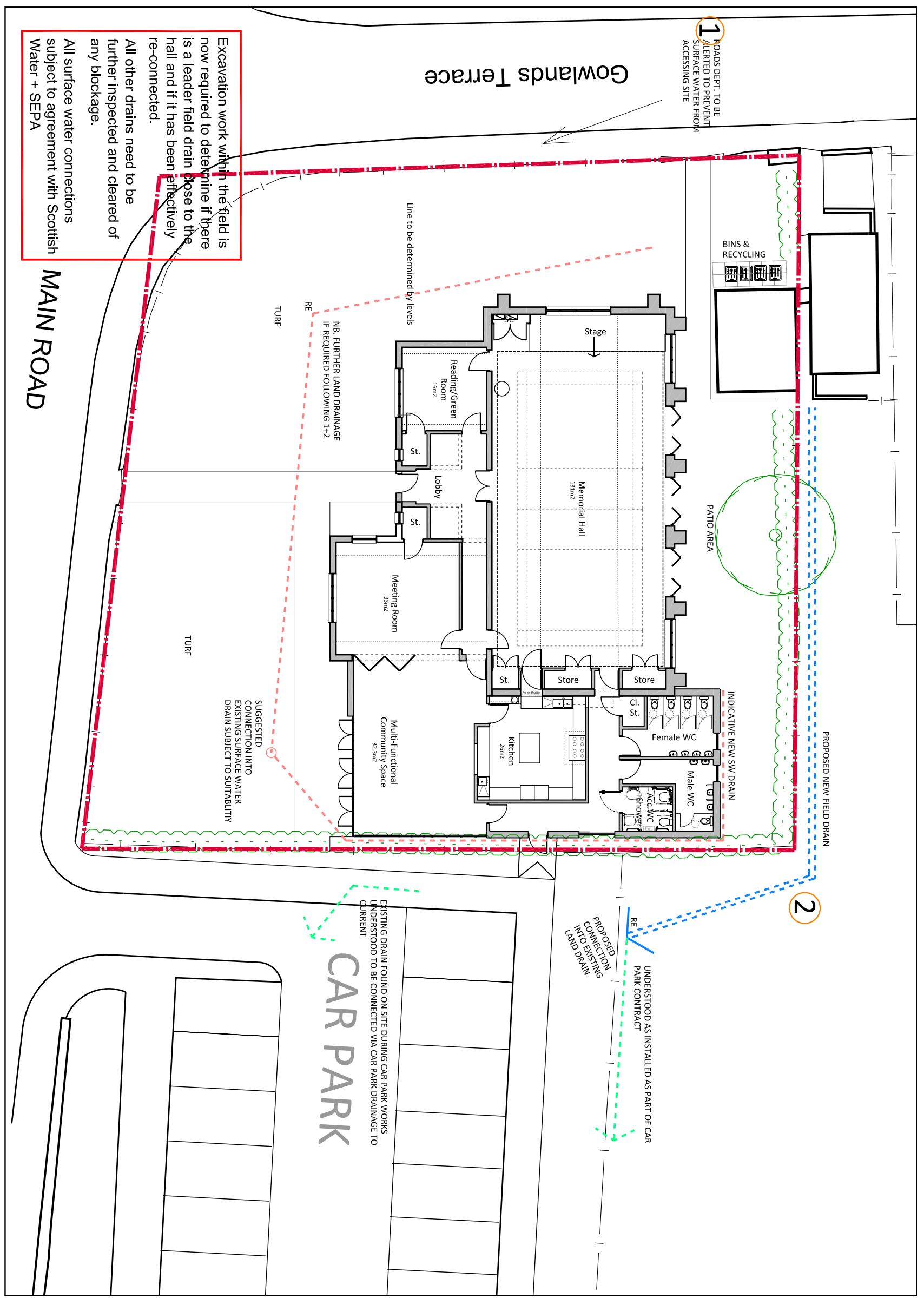

Rev	Date	Notes
A	19.06.13	Plan sign off by BMHGA on 13/06/13.
B	25.09.13	Site boundary updated to reflect Feu disposition drawings.
B	17.12.13	Additional site drainage information added

No.	Date	Description	RISK REGISTER

NOTES

**DO NOT SCALE**

The Contractor must check & verify all Site & Building Dimensions, Levels & Sewer Inverts at DCM's before commencing work. This Drawing must be read with the NBS Contract Specification and any related Structural Engineer or Specialist Contractors Drawings.

**COPYRIGHT:**

The information contained on this drawing is the sole copyright of anderson bell + christie & may not be reproduced without express written permission. Anderson Bell Christie Architects' License number for copy or display of OS Data is LIG0388.

**PLANNING**

Project: Returbishment of Barrhill Memorial Hall

Client: Barrhill Memorial Hall Community Association

Drawing: Proposed Site Plan

Job No.	Dwg No.	Rev.
1002	PL(0)100	C

Scale	Sheet	Scale	Sheet	Scale	Sheet
1:200	A3				

Dwgn CD	Date	Checked
	28/09/13	CB

**anderson bell + christie**  
architects

382 Great Western Road  
Glasgow G4 9HT  
T: (+44) 0141 339 1515  
F: (+44) 0141 339 0505  
E: gen@andersonbellchristie.com  
W: www.andersonbellchristie.com

CAD Ref: